



## 3 bed terraced house to buy in

Arthur Street, High Handenhold, Chester  
Le Street, Durham, DH2 1QE

# £95,000

 x3
  x1
  x1

Tenure

**Freehold**

On Street parking

## Property features

- ✓ Three Bedroom
- ✓ End Terrace
- ✓ Modern Kitchen and Bathroom
- ✓ Yard to the Rear
- ✓ EPC Rating D

## Key Information

- ✓ Council Tax: Band A
- ✓ EPC Rating: D
- ✓ Heating supply: Gas

## Description

Situated in the heart of High Handenhold, this well-presented 3-bedroom end-terrace property offers comfortable and practical living space ideal for families, first-time buyers, or investors.

The ground floor features a bright and welcoming lounge, a modern fitted kitchen, and a family bathroom. To the first floor there is three generously sized bedrooms, providing ample space for relaxation, working from home, or accommodating a growing family.

Externally the property benefits from a good sized private yard.

Located on a quiet residential street, Arther Street offers excellent access to local amenities, schools, and transport links, making it a convenient and desirable place to call home.

Viewing is highly recommended to fully appreciate the space and potential this property has to offer.

Council Tax Band: A

Tenure: Freehold

Price: £95,000

Property Type: Terraced House

Parking: On Street

Heating: Gas

## **Entrance Hallway**

Enter into welcoming hallway with central heating radiator and stairs leading to the first floor.

---

## **Lounge**

A double glazed window to the front, central heating radiator, feature fireplace and carpet to the floor.

---

## **Kitchen**

A double glazed window to the rear and external door leading to rear yard, a central heating radiator, a range of white fitted wall and base units with contrasting worksurfaces, single drainer stainless steel sink unit, plumbing for washing machine, splashback tiles and vinyl flooring.

---

## **Bathroom/Wc**

Situated on the ground floor with double glazed window to the rear, central heating radiator, white suite comprising low level wc, panelled bath with over head shower, pedestal wash hand basin, part tiled walls and vinyl to the floor.

---

## **First Floor Landing**

A double glazed window to the rear and built in storage cupboard.

---

## **Bedroom One**

A double glazed window to the front, central heating radiator and carpet to the floor.

---

## **Bedroom Two**

A second double bedroom with double glazed window to the rear, central heating radiator and carpet to the floor.

---

## **Bedroom Three**

A single bedroom with double glazed window to the front, central heating radiator and carpet to the floor.

Approx Gross Internal Area  
71 sq m / 768 sq ft

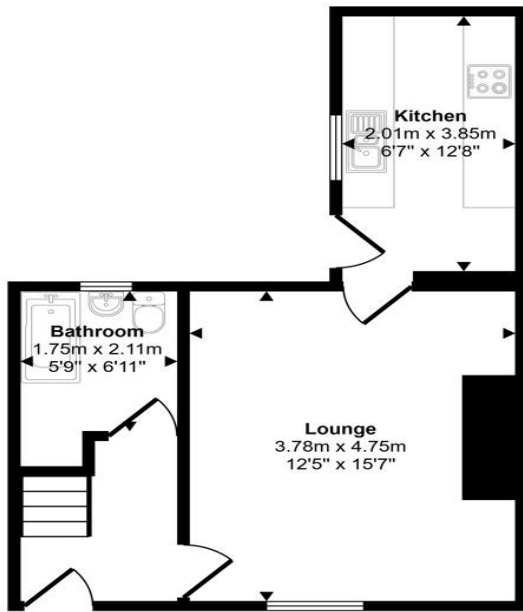

Ground Floor  
Approx 35 sq m / 382 sq ft

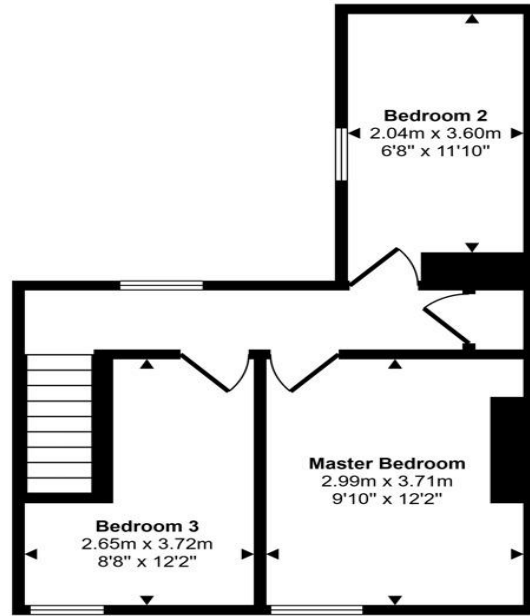

First Floor  
Approx 36 sq m / 386 sq ft

This floorplan is only for illustrative purposes and is not to scale. Measurements of rooms, doors, windows, and any items are approximate and no responsibility is taken for any error, omission or mis-statement. Icons of items such as bathroom suites are representations only and may not look like the real items. Made with Made Snappy 360.

Energy Efficiency Rating		
	Current	Potential
<i>Very energy efficient - lower running costs</i>		
(92-100) <b>A</b>		
(81-91) <b>B</b>		82
(69-80) <b>C</b>		
(55-68) <b>D</b>	68	
(39-54) <b>E</b>		
(21-38) <b>F</b>		
(1-20) <b>G</b>		
<i>Not energy efficient - higher running costs</i>		
<b>England, Scotland &amp; Wales</b>		EU Directive 2002/91/EC

Arthur Street, High Handenhold, Chester Le Street, Durham, DH2 1QE

Contact your local branch today for more information on this property:

**134 High Street, Peterborough, Cambridgeshire, PE2 8DP, [www.mandairs.co.uk](http://www.mandairs.co.uk)**

These particulars, whilst believed to be accurate are set out as a general outline only for guidance and do not constitute any part of an offer or contract. Intending purchasers should not rely on them as statements of representation of fact, but must satisfy themselves by inspection or otherwise as to their accuracy. No person in this firm's employment has the authority to make or give any representation or warranty in respect of the property.

