



3 bed terraced house to buy in

Coniscliffe Road, Hardwick,
Stockton-on-Tees, Durham, TS19 8QQ

£100,000

 x3
  x1
  x2

Tenure

Freehold

Off Street parking

Property features

- ✓ Three Bedroom Mid Terrace
- ✓ Offered With No Forward Chain
- ✓ Two Reception Rooms
- ✓ Close to North Tees Hospital
- ✓ EPC Rating C

Key Information

- ✓ Council Tax: Band A
- ✓ EPC Rating: C
- ✓ Heating supply: Gas

Description

A fantastic opportunity to acquire this well-proportioned three-bedroom terraced home, superbly located on Coniscliffe Road in the ever-popular Hardwick area. Ideally positioned close to North Tees Hospital, this residence offers convenience, space and strong future potential—perfect for first-time buyers, families or investors.

Upon entering through the porch, you are welcomed into a bright entrance hallway that leads to a generous lounge positioned to the front of the property. To the rear, you will find a separate dining area and kitchen, thoughtfully arranged to offer a more defined layout. The kitchen provides direct access to the garden and offers scope for reconfiguration to suit individual tastes. The first floor hosts three well-proportioned bedrooms, including two comfortable doubles, along with a neatly presented family bathroom. Externally, the property enjoys both front and rear gardens—the rear offering an attractive space for relaxation, entertaining or further landscaping.

Neatly maintained this home provides an excellent foundation for enhancement, ensuring strong appeal for those seeking a quality property in a thriving, well-connected area.

Early viewing is strongly recommended to appreciate the space, location and potential on offer.

Council Tax Band: A

Tenure: Freehold

Price: £100,000

Property Type: Terraced House

Parking: Off Street

Heating: Gas

Entrance Porch



Hallway

Lounge

4.15m x 3.60m (13'7" x 11'9")



Dining Room

2.79m x 2.69m (9'1" x 8'9")



Kitchen

2.79m x 2.75m (9'1" x 9'0")



Stairs to First Floor

Bedroom One

3.04m x 2.80m (9'11" x 9'2")



Bedroom Two

3.61m x 3.11m (11'10" x 10'2")



Bedroom Three

2.56m x 2.42m (8'4" x 7'11")



Bathroom W/C

2.47m x 1.86m (8'1" x 6'1")



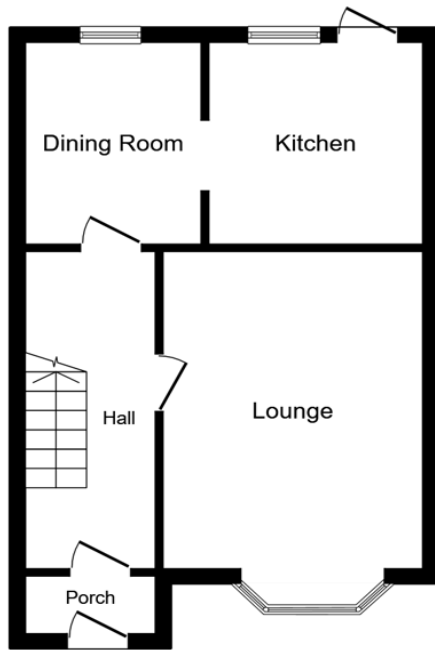

Ground Floor

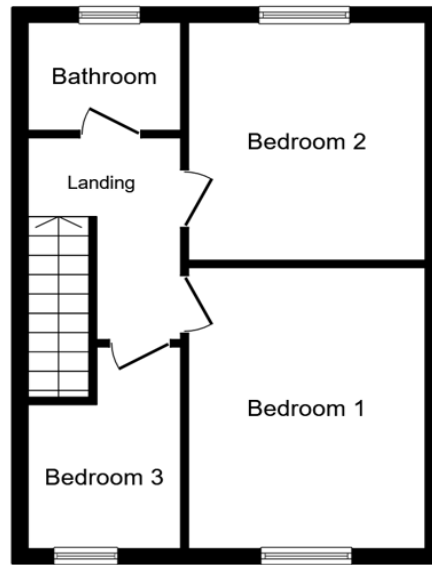

First Floor

This floor plan is for illustrative purposes only. It is not drawn to scale. Any measurements, floor areas (including any total floor area), openings and orientations are approximate. No details are guaranteed, they cannot be relied upon for any purpose and do not form any part of any agreement. No liability is taken for any error, omission or misstatement. A party must rely upon its own inspection(s). Powered by www.Propertybox.io

Energy Efficiency Rating		
	Current	Potential
<i>Very energy efficient - lower running costs</i>		
(92-100) A		
(81-91) B		
(69-80) C	70	77
(55-68) D		
(39-54) E		
(21-38) F		
(1-20) G		
<i>Not energy efficient - higher running costs</i>		
England, Scotland & Wales	EU Directive 2002/91/EC	

Coniscliffe Road, Hardwick, Stockton-on-Tees, Durham, TS19 8QQ

Contact your local branch today for more information on this property:

134 High Street, Peterborough, Cambridgeshire, PE2 8DP, www.mandairs.co.uk

These particulars, whilst believed to be accurate are set out as a general outline only for guidance and do not constitute any part of an offer or contract. Intending purchasers should not rely on them as statements of representation of fact, but must satisfy themselves by inspection or otherwise as to their accuracy. No person in this firm's employment has the authority to make or give any representation or warranty in respect of the property.

