



BELVOIR!

Property is personal

3 bed semi-detached house to buy in NG10

Ingleby Road, Long Eaton, Nottingham, Derbyshire, NG10 3DG

£190,000 Starting Bid

 x3
  x3
  x1

Tenure

Freehold

Driveway parking

Property features

-  Being Sold via Secure Sale online bidding. Terms & Conditions apply
-  Immediate 'exchange of contracts' available
-  Three bedroom semi detached property
-  Recently renovated kitchen and new carpets downstairs/stairs/landing and back

Key Information

- ✓ Council Tax: Band B
- ✓ EPC Rating: D
- ✓ Heating supply: Gas
- ✓ Electric supply: National Grid
- ✓ Water supply: Direct mains water
- ✓ Broadband: FTTC (fibre to the cabinet)
- ✓ Mobile signal: Good

Description

Being Sold via Secure Sale online bidding. Terms & Conditions apply.

** Three Bedroom Semi-Detached Home with Front & Rear Gardens and Driveway Parking **

This well-presented three-bedroom semi-detached property is located in the popular NG10 area, offering a spacious layout, private garden, and convenient access to local amenities.

The property comprises:

Entrance hallway with access to ground and first floor accommodation

Lounge with front aspect window

Recently renovated kitchen/dining area

Ample built-in storage throughout

Three well-proportioned bedrooms

Family bathroom with three-piece suite

Externally, the property benefits from both front and rear gardens, as well as a driveway providing off-street parking.

Location

Situated in NG10, the property is within easy reach of Long Eaton town centre, which offers a wide range of shops, supermarkets, schools, and healthcare facilities. The area is well served by public transport, with nearby bus routes and Long Eaton railway station providing access to Nottingham, Derby, and beyond. For those commuting by car, the A52, M1 motorway (Junction 25), and A50 are all easily accessible. Recreational spaces such as West Park and Trent Lock are also close by, offering opportunities for leisure and outdoor activities.

Please call to arrange a viewing!

Council Tax Band: B

Tenure: Freehold

Price: Starting Bid £190,000

Property Type: Semi-detached house

Parking: Driveway

Construction materials: Brick and block

Roofing type: Slate tiles

Risk of floods and or erosion: No

Flooded in last 5 years: No

Flood defences: No

Planning permissions or proposals for development: No

Coalfield or mining area: No

Listed property: No

Conservation area: No

Public rights of way: No

Adaptions for accessibility: No

Restrictions: No

Required access: No

Heating: Gas

Electric: National Grid

Water: Direct mains water

Sewerage: Standard UK domestic

Air conditioning: No

Broadband: FTTC (fibre to the cabinet)

Mobile signal coverage: Good

Ground Floor

Approx. 32.5 sq. metres (349.4 sq. feet)

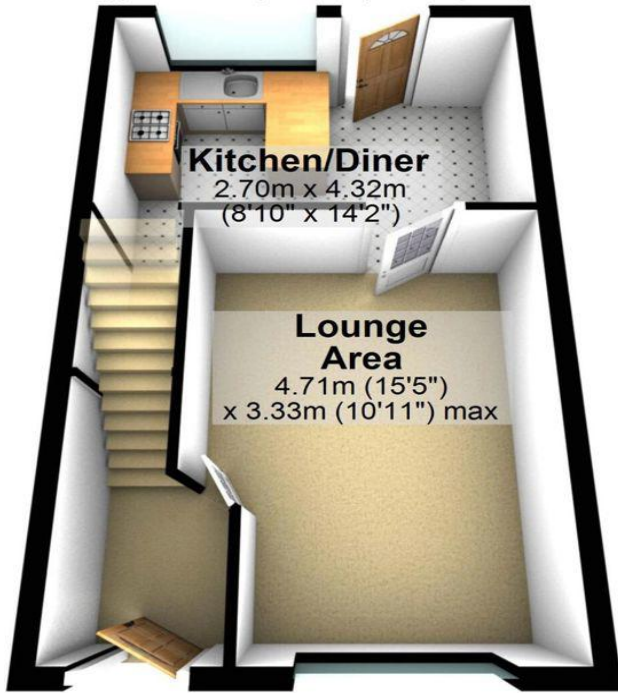

First Floor

Approx. 34.3 sq. metres (369.2 sq. feet)

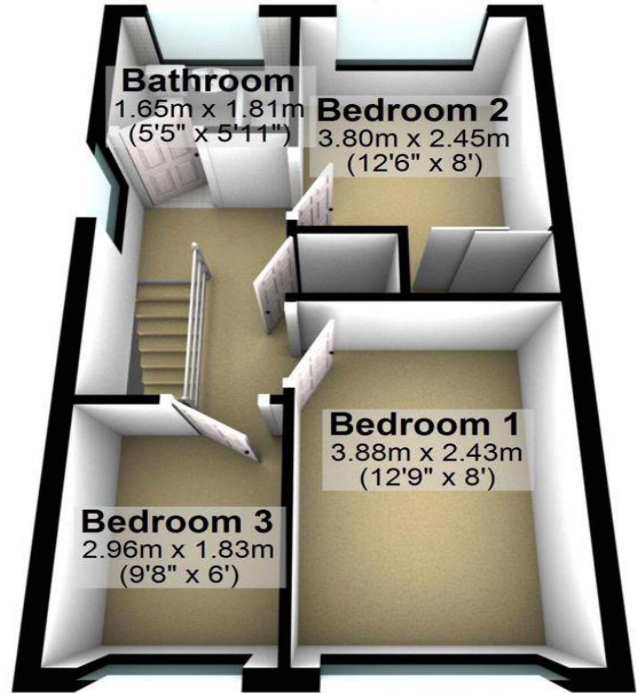

Total area: approx. 66.8 sq. metres (718.6 sq. feet)

Energy Efficiency Rating		
	Current	Potential
<i>Very energy efficient - lower running costs</i>		
(92-100) A		
(81-91) B		S1
(69-80) C		
(55-68) D	65	
(39-54) E		
(21-38) F		
(1-20) G		
<i>Not energy efficient - higher running costs</i>		
England, Scotland & Wales	EU Directive 2002/91/EC	

Ingleby Road, Long Eaton, Nottingham, Derbyshire, NG10 3DG

Contact your local branch today for more information on this property:

134 High Street, Peterborough, Cambridgeshire, PE2 8DP, www.mandairs.co.uk

These particulars, whilst believed to be accurate are set out as a general outline only for guidance and do not constitute any part of an offer or contract. Intending purchasers should not rely on them as statements of representation of fact, but must satisfy themselves by inspection or otherwise as to their accuracy. No person in this firm's employment has the authority to make or give any representation or warranty in respect of the property.

